

## **GATING REVIEW**

### **1. PURPOSE OF THE REPORT**

To inform members of the way Gating is being viewed by the Council now and provide statistics on usage and asb/crime for paths currently under scrutiny.

### **2. LABOUR PARTY MANIFESTO 2012**

Slough Labour Party's Manifesto Pledges for the Local Government Elections which were held on Thursday 3rd May 2012, included the following;

## **Housing and Community Safety**

If re-elected, by the next round of local elections in Slough, we will:

- Increase the number of 'alley-gates' installed, securing garage accesses and problem alleyways to improve safety and reduce anti-social behaviour.

As a result of this pledge the Council is taking a more direct approach in how it deals with Gating requests in the borough. Cases are reviewed on a regular basis with all crime/asb statistics pulled together and issues discussed to decide what action should be taken dependent on levels of crime/asb, usage and residents affected. Alternatives to Gating are always assessed and put in place if appropriate and feasible.

Council members are regularly informed of progress on individual cases by ward. The decision to go ahead with a gating order consultation remains an officer delegated function.

There is a commitment that the LAF will be consulted on cases requiring Gating Order consultations at the earliest opportunity. It has been made clear that the LAF also wants to be consulted on Gating schemes which are through routes where a Gating Order consultation is not required. Consultation with local residents is always undertaken, either through door knocking or letter.

### 3. USAGE SURVEY RESULTS

Usage survey Results for Footpath 4c		
Date	Usage both ways over 24 hours	
	Number of Cyclists	Number of Pedestrians
Tues 7th Feb 2012	4	49
Weds 8th Feb 2012	4	66
Thurs 9th Feb 2012	0	65
Fri 10th Feb 2012	3	55
Sat 11th Feb 2012	4	37
Tues 24th April 2012	6	52
Weds 25th April 2012	2	23
Thurs 26th April 2012	6	50
Fri 27th April 2012	4	48
Sat 28th April 2012	3	25

Site Plan Footpath 4c – Cippenham

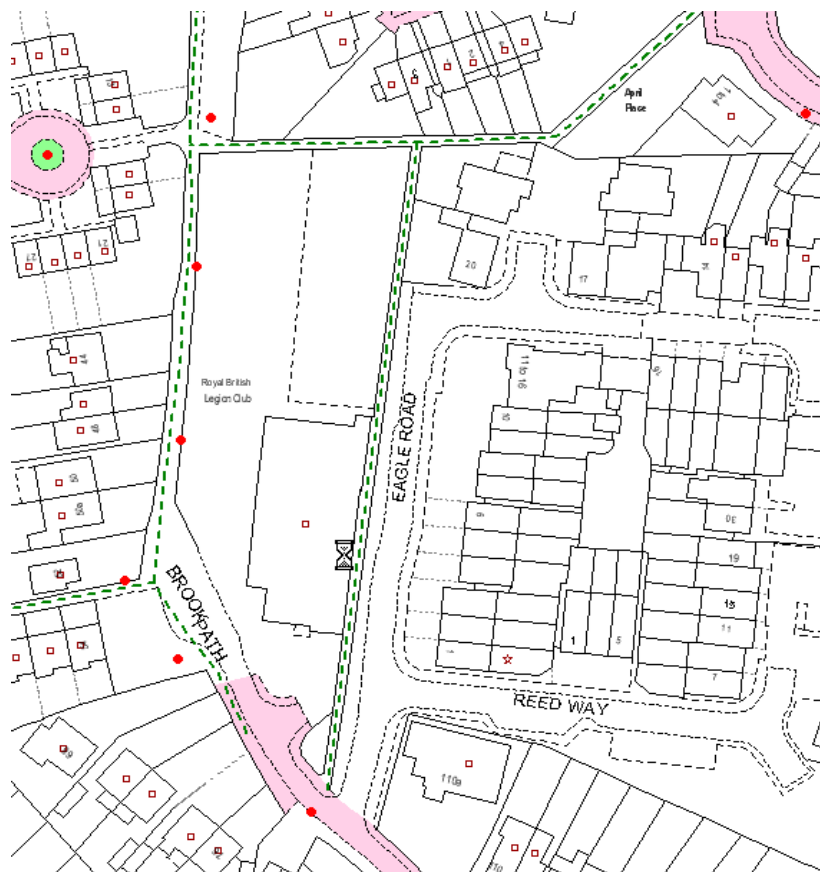

LOCAL ACCESS FORUM REPORT – 12<sup>th</sup> JULY 2012 – AGENDA ITEM 6

Usage survey Results for Footpath between Myrtle Crescent and Lismore Park		
Date	Usage both ways over 24 hours	
	Number of Cyclists	Number of Pedestrians
Tues 24th April 2012	3	372
Weds 25th April 2012	10	218
Thurs 26th April 2012	5	283
Fri 27th April 2012	11	299
Sat 28th April 2012	4	118

Site Plan Myrtle Crescent to Lismore Park



# LOCAL ACCESS FORUM REPORT – 12<sup>th</sup> JULY 2012 – AGENDA ITEM 6

## Usage survey Results for Footpath 56 (part) between 40 and 42 Cranbourne Close

### Usage both ways over 24 hours

Date	Number of Cyclists	Number of Pedestrians
Tues 24th April 2012	21	137
Weds 25th April 2012	8	115
Thurs 26th April 2012	12	127
Fri 27th April 2012	14	125
Sat 28th April 2012	14	98

## Site Plan for Footpath 56 (part) between 40 and 42 Cranbourne Close

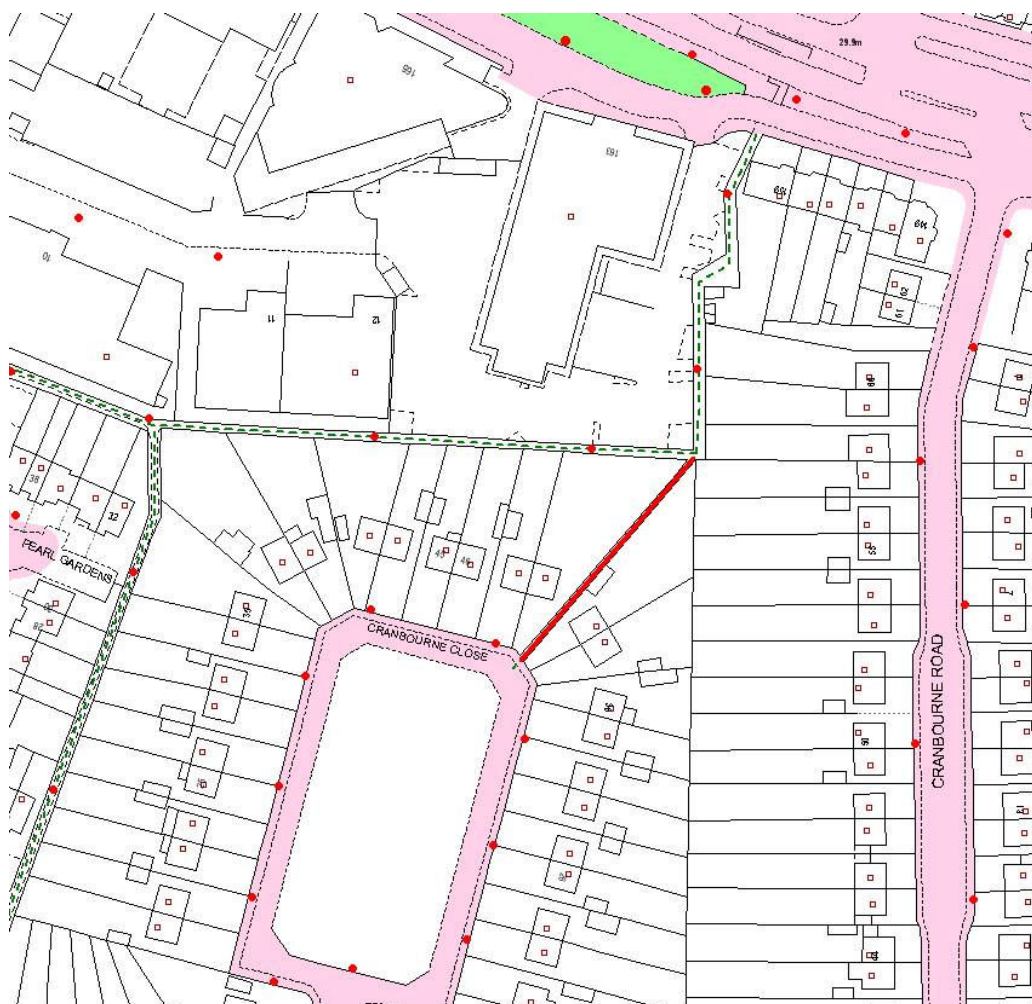

# LOCAL ACCESS FORUM REPORT – 12<sup>th</sup> JULY 2012 – AGENDA ITEM 6

## Usage survey Results for Footpath 31 – Tuns Lane crossover

Date	Usage both ways over 24 hours	
	Number of Cyclists	Number of Pedestrians
Tues 24th April 2012	6	51
Weds 25th April 2012	7	34
Thurs 26th April 2012	2	20
Fri 27th April 2012	4	40
Sat 28th April 2012	2	18

## Site Plan for Footpath 31 Tuns Lane crossover

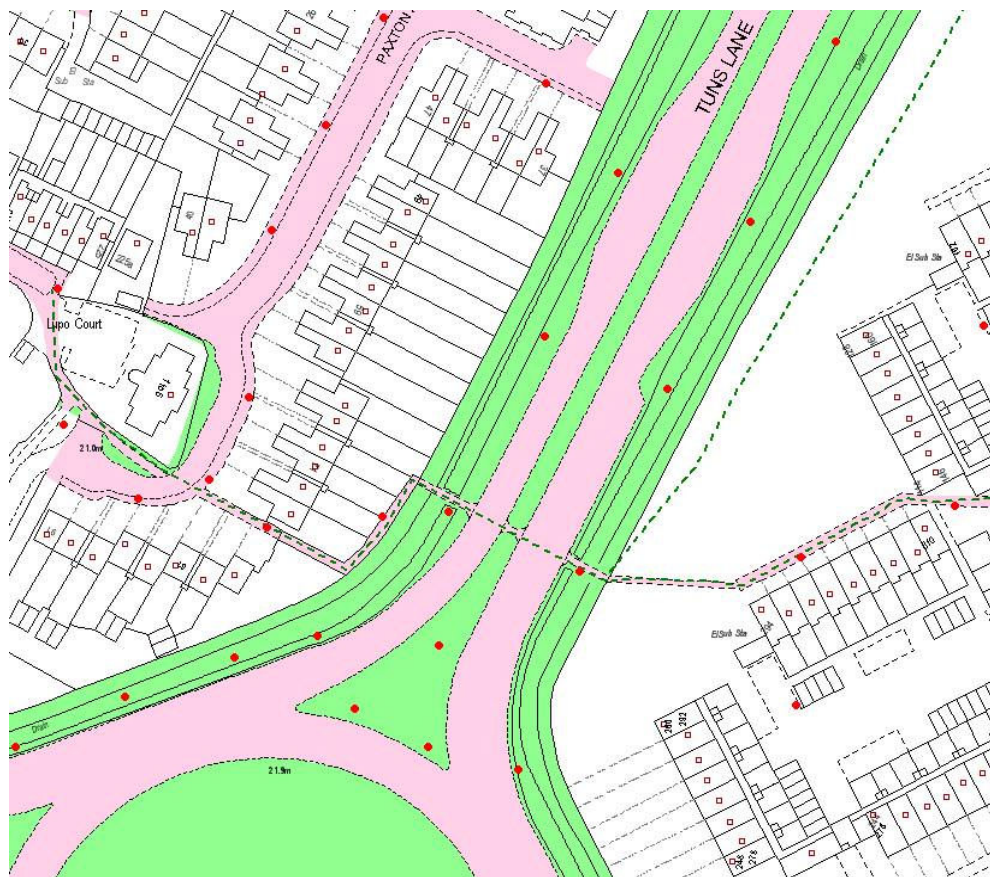

# LOCAL ACCESS FORUM REPORT – 12<sup>th</sup> JULY 2012 – AGENDA ITEM 6

<b>Usage survey Results for Footpath 57 – Glentworth Place to Tuns Lane</b>		
<b>Usage both ways over 24 hours</b>		
<b>Date</b>	<b>Number of Cyclists</b>	<b>Number of Pedestrians</b>
Tues 24th April 2012	3	49
Weds 25th April 2012	1	36
Thurs 26th April 2012	5	29
Fri 27th April 2012	5	35
Sat 28th April 2012	4	40

Site Plan for Footpath 57 between Glentworth Place and Tuns Lane

